

**LOJEL**

**LOCK  
INSTRUCTIONS**

1010  
1010  
1010

TSA007

OPEN

## Lock #E-297

---

**EXOS I**

**EXOS II**

**EXOS III**

**GROOVE (ZIPPER VERSION)**

**HATCH**

**LUCID**

**STREAMLINE**

**WAVE**

**LUNA**

**VITA**

**HORIZON (CABIN ZIPPER ONLY)**

**RANDO (ZIPPER VERSION)**

**LUMO**

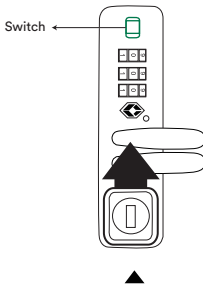

**PUSH UP  
BUTTON  
TO OPEN**

## How to use the dial lock?

1. When you purchase the suitcase, the dial is set at 0-0-0.
2. Slide the switch and hold it for setting the combination.  
Spin the dials to your chosen combination numbers, then release the switch and your combination is set.

## Lock #181

---

### NIMBUS

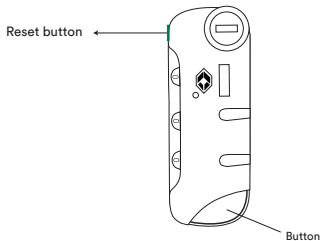

**PUSH UP  
BUTTON  
TO OPEN**

### How to use the dial lock?

1. When you purchase the suitcase, the dial is set at 0-0-0.
2. Push the reset button and hold it for setting the combination.  
Spin the dials to your chosen combination numbers, then release the switch and your combination is set.

## Lock #16009

---

CUBO  
NOVA  
JUNA  
LUCID 2 (M/L)

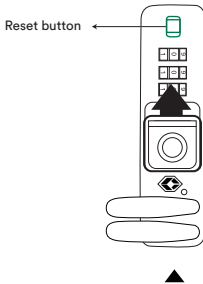

PUSH UP  
BUTTON  
TO OPEN

## How to use the dial lock?

1. When you purchase the suitcase, the dial is set at 0-0-0.
2. Push the reset button and hold it for setting the combination.  
Spin the dials to your chosen combination numbers, then release the switch and your combination is set.

# Lock #13233

---

**RANDO** (FRAME VERSION)

**TEMPO**

**GROOVE 2**

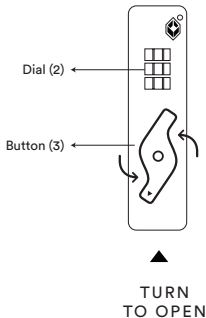

## How to reset combinations

The original combination is 0-0-0. Pls remember to reset your own combination as the follow steps:

1. Turn the reset button(1) on the backside of the lock from "A" to "B"
2. Turn the dials(2), to your selected numbers to the middle of the panel(e.g.:888);
3. Turn the reset button(1)to "A". Then you have finished resetting your own combinations.

## How to use the lock?

1. Dial the correct combination to the middle of the panel, the lock is unlocked when you rotate the button(3) aligning at the green dot and pull the case body.
2. Close the case body, then turn the dials randomly to conceal the combination youset then set then the lock is locked.

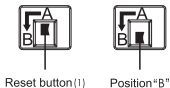

## KOZMOS (PILOT CASE) NOVIGO

### How to reset the combination:

The original number is 0-0-0. If you want to reset the number, pls follow the below steps:

1. Turn the resettable button(1) from "A"to"B"
2. Dial the numbers(2) to any number you selected(e.g.:888)
3. Turn the resettable button(1) to "A". Till now, you can open the lock with the new numbers.

### How to use the combination lock

1. Align the correct numbers to the indication line,then push the button to open the lock
2. Press down the lock body to latch the luggage,then turn the dials randomly to lock it.

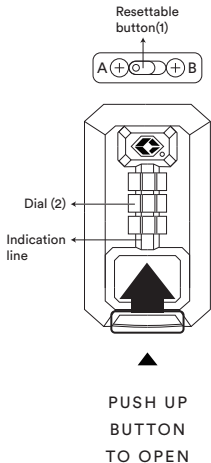

## Lock #9921

---

### KOZMOS (KEY LOCK EDITION)

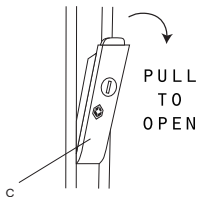
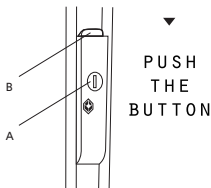

### How to use the key lock?

This TSA lock is assigned one customized key inside the trolley case.

#### How to unlock :

1. Put the key into (A), and turn right (clockwise) to open the lock.
2. Push the button (B), and lift it to open the suitcase.

#### How to lock :

1. Close the lock (C), and put the key into (A), turn left (counter-clockwise) to lock.

## Lock #C-999

---

### HORIZON KOZMOS (INTER LOCK EDITION)

#### How to use the dial lock?

##### How to unlock:

1. The original setting of the combination lock is 0-0-0.
2. Push side buttons (B) inward and lift (C) to open the side locks.

##### How to lock :

1. Make sure the combination lock and side locks are unlocked.
2. Push down the two side locks (C) to close the case.
3. Spin the dials of the combination lock to random numbers.

#### How to set or re-set the TSA combination lock :

1. Spin the dials (A) to 0-0-0 (original setting) or last combination setting.
2. Open the trolley case to locate the rest lever (D) with red plastic cover behind the combination lock. Remove the red protection cover and push the rest lever (D) from (E) to (F) position.
3. Turn the combination dials (A) to your newly chosen three-digit number.
4. Return the rest lever to the original position (E) in order to set the number dials at your newly chosen numbers. Place the red protection cover back onto the rest lever.

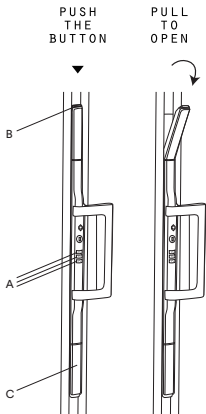



## CARAPACE

PUSH  
THE BUTTON  
UP TO OPEN



### How to use the dial lock?

#### How to unlock:

1. The original setting of the combination lock is 0-0-0.
2. Push side buttons (B) outward to open the side locks.

#### How to lock:

1. Make sure the combination lock and side locks are at the unlocked position.
2. Push down the two side locks (C) to close the case.

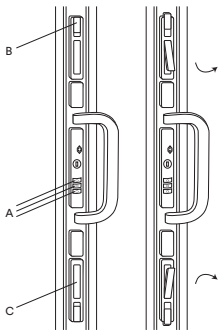

### How to set or re-set the TSA combination lock:

1. Spin the dials (A) to 0-0-0 (original setting) or last combination setting.
2. Open the trolley case to locate the rest lever (D) with red plastic cover behind the combination lock. Remove the red protection cover and push the rest lever (D) from (E) to (F) position.
3. Turn the combination dials (A) to your newly chosen three-digit number.
4. Return the rest lever to the original position (E) in order to set the number dials at your newly chosen numbers. Place the red protection cover back onto the rest lever.



## OCTA OCTA 2

### How to unlock:

As shown in illustration 2, the push button must be positioned at (A) to unlock, then lift the (B) lever plate upward to open.

### How to lock:

As shown in illustration 1, slide the push button downward following the arrow sign to be positioned at (A) for locking.

\*Locks provide protection against accidental opening and help protect your property.

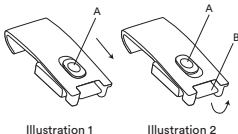

## How to use the dial lock?

This combination dial zip lock is initially set at 0-0-0.

### 1. To reset combination:

You can use the original code of 0-0-0 or follow the steps below to reset:

Push the setting lever (A) downward following the arrow direction. Turn the combination dials (B), and select a new three-digit number. Push the setting lever (A) back to its original position and your combination is set.

### 2. To lock:

Turn the combination dials (B) to lock.

### 3. To unlock:

Turn the combination dials (B) to the three-digit combination. Press and lift the lever plate (C) to unlock.

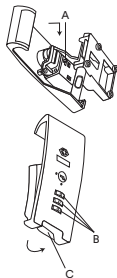

# Lock #13131

---

## LUCID 2 (S)

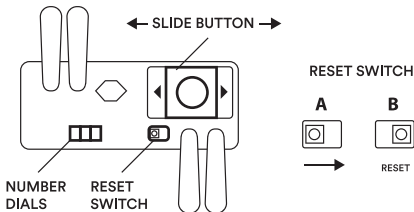

## How to reset

Please set your personal combination by following these simple steps :

1. Make sure the Number Dials are set to 0-0-0 to ensure it is open.
2. Engage the Reset Switch by sliding it right from position A to B.
3. Rotate the Number Dials to your preferred combination.
4. Disengage the Reset Switch by sliding left from position B, to A.  
You have now set your combination.
5. Rotate the Number Dials to a random combination of numbers to lock.  
To reset again, start from your preferred combination, and repeat steps 2 to 4.

## How to open

Push the Slide Button left, or right, to release the zipper pullers.

1. Push left for access to the main compartment.
2. Push right for access to the front compartment.

---

## TSA Lock® System use

Using this Travel Sentry® approved lock allows your luggage to be unlocked and inspected by security authorities without damage.

When security inspectors must inspect luggage:

Bags without TSA lock®: Security inspectors must cut open the bag destroying the lock to inspect the bag.

Bags with TSA lock®: Security inspectors have secured tools that can open the lock to inspect the bag.

Bags with TSA lock® can be inspected without the lock being destroyed for inspection.



### Notice:

The TSA screener and the airline check-in staff are being trained to recognize the Travel Sentry® mark, so that they understand that baggage with this special mark is permitted to remain locked. The TSA screeners have access to special tools that allow them to open baggage in the event that they must be opened for inspection. Travel Sentry® approved locks enable the TSA screeners to open luggage quickly for physical inspection when required without the need to cut off or break open locks.

### How it works:

1. Each Travel Sentry® Approved Lock has a special identification mark alerting the TSA and other airport security agencies that they can open this lock without destroying it.
2. Each of these locks has a special code, which is used by the TSA and other security agencies to know which tool to use to open the lock.
3. Every security screening location at all US airports and now many other international airports are able to open the lock and then relock it after inspection.

The logo consists of a solid green square with the word "LOJEL" written in white, italicized, uppercase letters in the center.

***LOJEL***

LOJEL.COM